COUNCIL BULLETIN

Issue Number 19/2018
Friday, 11 May 2018

Epping Forest District Council
www.eppingforestdc.gov.uk

Compiled, designed and produced by
The Directorate of Governance - Democratic Services

Assistant Director – Governance - Simon Hill
Telephone: 01992 564000



PART A - FORWARD DIARY

Key to abbreviations:

CC	Council Chamber	Cab Off	Cabinet Office
CR1	Committee Room 1	CONF	Conference Room (1st floor)
CR2	Committee Room 2	CH OFF	Chairman of Council's Office
MR	Members' Room	TR RM	Training Room
TBD	To be decided	HEM	Hemnal Street Offices.
TBN	To be noted		
TBC	To be confirmed		Meeting being filmed for subsequent viewing

Other venues are shown in full.

Week One: 14 May 2018 – 20 May 2018

Monday 14 May	7.00pm	Local Plan Cabinet Committee		CC
Tuesday 15 May				
Wednesday 16 May	10.00am 6.00pm 7.00pm	Licensing Sub-Committee Briefing – Area Plans Sub-Committee West Area Planning Sub-Committee West		CC CR1 CC
Thursday 17 May				
Friday 18 May	9.00am ~ 5.00pm	Member Training – Full day		CR1
Saturday 19 May				
Sunday 20 May				

Week Two: 21 May 2018 – 27 May 2018

Monday 21 May				
Tuesday 22 May				
Wednesday 23 May				
Thursday 24 May	6.30pm 7.30pm	Council – Chairman's Briefing Council		CR1 CC
Friday 25 May				
Saturday 26 May				
Sunday 27 May				

Week Three: 28 May 2018 – 3 June 2018

Monday 28 May				
Tuesday 29 May				
Wednesday 30 May	6.30pm 7.30pm	Briefing – Area Plans Sub-Committee South Area Planning Sub-Committee South		CR1 CC
Thursday 31 May				
Friday 1 June				
Saturday 2 June				
Sunday 3 June				

Week Four: 4 June 2018 – 10 June 2018

Monday 4 June	6.00pm 7.30pm	Senior Management Selection Panel Overview and Scrutiny Committee		CR1 CC
Tuesday 5 June	10.00am 7.00pm 7.00pm	Licensing Sub-Committee Youth Council Member Training – O&S		CC CC CR1
Wednesday 6 June	7.30pm	District Development Management Committee		CC
Thursday 7 June				
Friday 8 June				
Saturday 9 June				
Sunday 10 June				

PART B - GENERAL INFORMATION

1. LGA 2018/19 COUNCILLOR'S GUIDE

Please find below a link for the Local Government Association's 2018/19 Councillor's Guide.

<https://www.local.gov.uk/our-support/highlighting-political-leadership/councillors-guide>

2. SENIOR MANAGEMENT SELECTION PANEL

The meeting of the Senior Management Selection Panel due to be held on 31 May 2018 has been cancelled. With the agreement of the Leader of the Council, the meeting of the Panel will now be held at 5.00pm on 4 June 2018, prior to the meeting of the Overview and Scrutiny Committee meeting that evening.

(Further information: Steve Tautz ext 4180)

3. ECC FOOTPATH MODIFICATIONS - NAZEING (Pages 13 - 36)

Please see attached.

4. CHAIRMAN'S DIARY (Pages 37 - 38)

Please see attached.

LICENSING ACT 2003

Please be advised that the Licensing Unit has received the following applications for New Premises Licence made under the Licensing Act 2003 for the premises below:

Applicant name East 15 Acting School

Address of Premises: East 15 Acting School & Corbett Theatre, Rectory Lane, Loughton, Essex, IG10 3RY

Brief details of the nature of the application; This is a new premises licence. This application is for a duplicate Premises Licence for the above premises that was granted on 30/04/2018. This premises licence application is for a Shadow Premises Licence and has the same identical hours, conditions and licensable activities.

Consultation period from 3rd May 2018 To 30th May 2018

Officer in charge: Handan Ibrahim

Please ensure that any comments/objections are received by the Licensing team on or before the consultation end date.

Manager	Kim Tuckey 01992 564034
Licensing Compliance Officer	Sarah Moran 01992 564270
Licensing Compliance Officer	Nuala Clark 01992 564340
Licensing Compliance Officer	Joanne Owen 01992 56 4721
Licensing Compliance Officer	Handan Ibrahim 01992564153
Licensing Officer	Jane Mullinger 01992 564461

GOVERNANCE DIRECTORATE - PLANNING

1. Appeals Lodged

EPF/2528/17 – Littlecroft Nurseries, Abridge Road Theydon Bois Essex CM16 7NR - Demolition of detached bungalow and erection of replacement (Revised application to EPF/1134/17) – Written reps – Jonathan Doe ext. 4103

EPF/3036/17 – 1 Woodbury Hill Loughton Essex IG10 1JB - Removal of further sections of roof above ground floor addition at the rear, and raising of the roof of part of ground floor back addition - representing revisions to previously approved scheme ref EPF/2744/16 – Householder appeal – David Baker ext, 4514

EPF/3197/17 – 69 Farm Hill Road Waltham Abbey Essex EN9 1NG - Demolition of existing bungalow. Construction of 3 storey block of 7 flats. Re-submission of refused application: EPF/2596/16 – Written reps - Graham Courtney ext. 4228

EPF/3259/17 – 121 Theydon Grove Epping Essex CM16 4QB - Proposed single storey side extension and garden wall – Householder appeal - Steve Andrews ext. 4337

EPF/3364/17 – 119 Theydon Park Road Theydon Bois Essex CM16 7LS - Demolition of existing dwelling, erection of replacement dwelling and front boundary fence. Erection of detached garage and relocate vehicular access point - Hearing – Sukhvinder Dhadwar ext. 4597

2. Forthcoming Planning Inquiries/Hearings -

31/07/2018 – EPF/3364/17 – 119 Theydon Park Road Theydon Bois Essex CM16 7LS – Sukhvinder Dhadwar

3. Enforcement Appeals

None this week

4. Appeal Decisions

ENF/0328/16 – School Knotts Middle Street Nazeing Essex EN9 2LQ – Rear extension not as

EPF/2241/14 – Dismissed

EPF/2728/16 – School Knotts Middle Street Nazeing Essex EN9 2L1 - Retrospective planning application to retain first floor side extension, ground floor front porch extension and external railings to front and rear roof areas. Flat roofs are not accessible except for maintenance – Part allowed and part dismissed

EPF/2064/17 – 142 Buckhurst Way Buckhurst Hill Essex IG9 6HP - Demolition of

bungalow and construction of two-storey block of four flats with rooms in roof and integral carport – Allowed with conditions

5. Tree Preservation Orders

None this week

6. S106 Agreements

None this week

7. Changes to Planning Systems

None this week

PROPOSED PLANNING ENFORCEMENT ACTION

None this week

It is important to note, that when enforcement action has been authorised, this includes any subsequent action under Part VII of the Town and Country Planning Act 1990, including a prosecution or an injunction.

Principal Planning Enforcement Officer	Jerry Godden	01992 564498
Senior Enforcement Officer	Clare Munday	01992 564114
Planning Enforcement Officers	Sharon Hart	01992 564530
	David Thompson	01992 564108
	James Gordon	01992 564530
	Zara Seelig	01992 564379

PART C - PORTFOLIO HOLDER DECISIONS

The notification of decisions taken by individual Portfolio Holders is no longer included in the Council Bulletin.

All members of the Council receive automatic email notification of the publication of each individual Portfolio Holder decision and the call-in period for each decision commences immediately. Members wishing to call-in a decision should complete the attached call-in form and return it to Democratic Services before the expiry of five working days following the publication date of the decision. Members should refer to the Constitution (Article 6 - Overview and Scrutiny) for the rules of call-in.

ELS
Seax House
Victoria Road South
Chelmsford
CM1 1QH

Epping Forest District Council
Director of Environment & Street Scene
Civic Offices
High Street
Epping Essex
CM16 4BZ

Our Ref: MM/HIGH/9454
Your Ref:
Date: 1 May 2018

EPPING FOREST DISTRICT COUNCIL NEIGHBOURHOODS	
REC'D	02 MAY 2018
ACK
REFERRED TO

Dear Sirs

Wildlife and Countryside Act 1981, section 53
The Essex County Council Definitive Map Modification No. 617 Footpath 59
Nazeing (Epping Forest District) 2016

Further to previous correspondence, the above mentioned Order was confirmed by the County Council on 24 April 2018. I enclose three copies of the confirmed Order, together with two copies of the formal Notice of the confirmation in accordance with Paragraph 11 of Schedule 15 to the Wildlife and Countryside Act 1981.

Would you please arrange for one copy of the Notice to be displayed at your Council offices, and for a copy of the confirmed Order to be available for public inspection as indicated in the Notice.

As the Order modifies the Definitive Map, it should be kept available for public inspection with the copies of the Definitive Map for the District and I should be grateful if you would arrange for this.

Please also ensure that your Land Charges Department is aware that the Order has been confirmed, together with the District Planner.

If you wish to note the face of the Definitive Map and Statement to refer to the Order and its confirmation, please only use a pencil so that it is abundantly clear to anyone inspecting them that the entry is not part of the original map and statement.

Any enquiries regarding the content of the Order or the associated case should be directed to Mary Morris on 03330 139679.

Yours faithfully

ELS

First for Public Law



Mary Morris
Chartered Legal Executive

DX 123300 Chelmsford 7

Telephone: 03330 139679

Fax: 01245 506650

Internet: www.elslegal.org.uk

Email: mary.morris@essex.gov.uk

Lexcel
Legal Practice Quality Mark
Law Society Accredited

Lexcel is the Law Society's legal practice quality mark for excellence.

Wildlife and Countryside Act 1981

The Definitive Map and Statement for the County of Essex

The Essex County Council Definitive Map Modification No. 617
Footpath 59 Nazeing (Epping Forest District) Order 2016

This Order is made by Essex County Council under Section 53(2)(b) of the Wildlife and Countryside Act 1981 "the Act" because it appears to that authority that the Definitive Map and Statement for the County of Essex requires modification in consequence of the occurrence of an event specified in Section 53(3)(c)(i) & (iii) namely, the discovery by the authority of evidence which (when considered with all other relevant evidence available to them) shows (i) that a right of way which is not shown in the map and statement subsists or is reasonably alleged to subsist over land in the area to which the map relates, being a right of way to which this Part applies and (iii) that there ~~is no public right of way over land shown in the map and statement as a highway of any description, or any other particulars contained in the map and statement require modification.~~

The authority has consulted with every local authority whose area includes the land to which the order relates. The Essex County Council hereby order that:

For the purpose of this order the relevant date is 1 February 2016.

The Definitive Map and Statement for the County of Essex shall be modified as described in Part I and Part II of the Schedule and shown on the map attached to the Order.

This order shall take effect on the date it is confirmed and may be cited as the Essex County Council Definitive Map Modification No. 617 Footpath 59 Nazeing (Epping Forest District) Order 2016.

Given under the Common Seal of the Essex County Council this 15 day of February in the year Two Thousand and Sixteen .

The COMMON SEAL of the ESSEX)
COUNTY COUNCIL was hereunto)
Affixed in the presence of:)

Attesting Officer

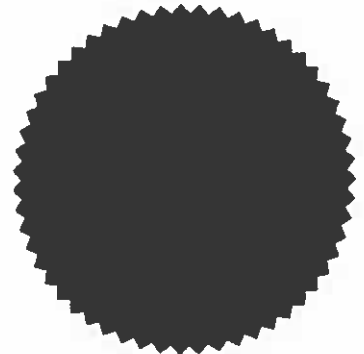

35177

The foregoing order is hereby confirmed subject to the red ink modifications thereon

Mark Yates 24 APR 2018

An Inspector appointed by The Secretary of State for Environment, Food and Rural Affairs

The footpath proceeds along the western and northern boundaries of the land held within Land Registry Title Number EX292306 (points G-B-H on the attached map). It then continues along the southern boundary of the land immediately to the north of registered Title Number EX292306 (points H-D on the attached map).

SCHEDULE

PART I

Modification of Definitive Map

Description of path or way to be added:

A length of Footpath 59 Nazeing, from Waltham Road (Nazeing Long Green) at the western boundary of the property known as "Selways" in a north north westerly direction for a distance of 70 metres then turning north east for a distance of 55 metres to join the unaffected part of the route. The width of the added section is four feet (1.22 metres)

~~Description of path or way to be deleted:~~

~~A length of Footpath 59 Nazeing from a point D on the order plan in a south-south-easterly direction for a distance of 70 metres to meet the Waltham Road at Point A.~~

PART II

Modifications of Definitive Statement

Variations of particulars of path or way

The statement for the parish of Nazeing shall be amended to read as follows:

OS Sheet No.	Path No.	Classification	Position and Description
40 NW, SW 4005- 4004	59	FP	<p>From Middle Street and the access track to the dwellings of Bumbles Green Farm leading south-westwards adjacent to and on the north side of the ditch to a culvert where it deviates around a large tree over the culvert. Then immediately re-joining the north side of the ditch to a point opposite the property known as Jamesmead, approximately 220 mt south-west of Middle Road. Up to this point the path has a width of 1.5 mt and shall be no less than 1 metre from the brow of the ditch.</p> <p>Then continuing in the same direction to a point approximately 226 metres south-west of Middle Street. This section has a width of 1.5 mt and shall be no less than 2mt from the brow of the ditch, on the north side of the ditch.</p> <p><i>The second section numbered 59a continues. Then continuing at a width of 1.22 metres in a south westerly direction for a distance of 35 metres, before crossing the boundary on to Selways where it continues in the same direction for 20 metres. It then turns south-south-east along the western boundary of Selways for a distance of 70 metres to meet the Waltham Road.</i></p>

The path then splits into one section, with an unspecified width, leading eastwards to meet Waltham Road.

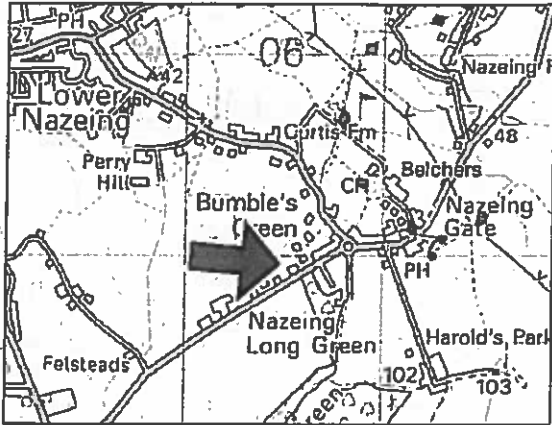

Key

Footpath 59 Nazeing

~~Delete Route A - D~~

Add Route G - B - H - D

Unaffected Route

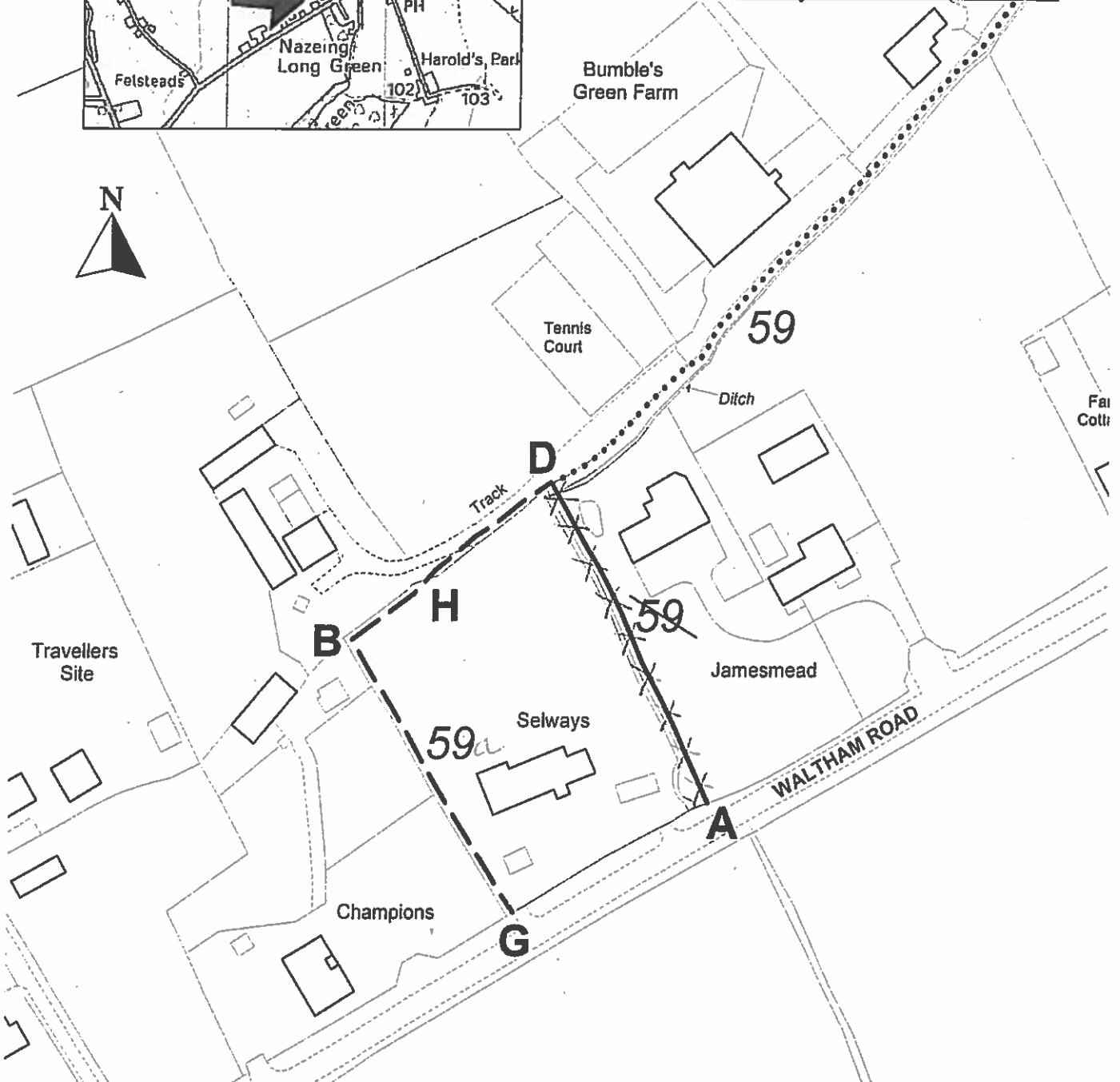

The Essex County Council Definitive Map Modification No. 617 (Footpath 59 Nazeing, Epping Forest District) Order 2016

Definitive Map Sheet TL40SW Scale 1:1250
Grid Ref TL406,049 or 5406,2049



Essex County Council

© Crown copyright and database rights
Ordnance Survey Licence No. 100019802

Wildlife and Countryside Act 1981

The Definitive Map and Statement for the County of Essex

**The Essex County Council Definitive Map Modification No. 617
Footpath 59 Nazeing (Epping Forest District) Order 2016**

This Order is made by Essex County Council under Section 53(2)(b) of the Wildlife and Countryside Act 1981 "the Act" because it appears to that authority that the Definitive Map and Statement for the County of Essex requires modification in consequence of the occurrence of an event specified in Section 53(3)(c)(i) & (iii) namely, the discovery by the authority of evidence which (when considered with all other relevant evidence available to them) shows (i) that a right of way which is not shown in the map and statement subsists or is reasonably alleged to subsist over land in the area to which the map relates, being a right of way to which this Part applies and (iii) that there ~~is no public right of way over land shown in the map and statement as a highway of any description, or any other particulars contained in the map and statement require modification.~~

The authority has consulted with every local authority whose area includes the land to which the order relates. The Essex County Council hereby order that:

For the purpose of this order the relevant date is 1 February 2016.

The Definitive Map and Statement for the County of Essex shall be modified as described in Part I and Part II of the Schedule and shown on the map attached to the Order.

This order shall take effect on the date it is confirmed and may be cited as the Essex County Council Definitive Map Modification No. 617 Footpath 59 Nazeing (Epping Forest District) Order 2016.

Given under the Common Seal of the Essex County Council this 15 day of February in the year Two Thousand and Sixteen .

The COMMON SEAL of the ESSEX)
COUNTY COUNCIL was hereunto)
Affixed in the presence of:)

Attesting Officer

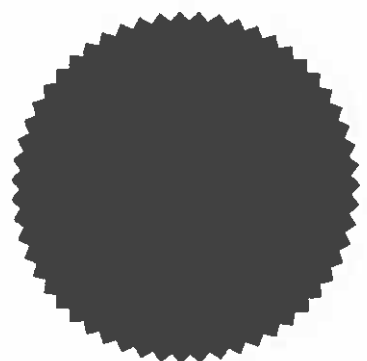

The foregoing order is hereby confirmed subject to the red ink modifications thereon

Mark Yates 24 APR 2018

An Inspector appointed by The Secretary of State for Environment, Food and Rural Affairs

The footpath proceeds along the western and northern boundaries of the land held within Land Registry Title Number EX292306 (points G-B-H on the attached map). It then continues along the southern boundary of the land immediately to the north of registered Title Number EX292306 (points H-D on the attached map).

SCHEDULE

PART I

Modification of Definitive Map

Description of path or way to be added:

A length of Footpath 59 Nazeing, from Waltham Road (Nazeing Long Green) at the western boundary of the property known as "Selways" in a north north westerly direction for a distance of 70 metres then turning north east for a distance of 55 metres to join the unaffected part of the route. The width of the added section is four feet (1.22 metres)

~~**Description of path or way to be deleted:**~~

~~A length of Footpath 59 Nazeing from a point D on the order plan in a south-south-easterly direction for a distance of 70 metres to meet the Waltham Road at Point A.~~

PART II

Modifications of Definitive Statement

Variations of particulars of path or way

The statement for the parish of Nazeing shall be amended to read as follows:

OS Sheet No.	Path No.	Classification	Position and Description
40 NW, SW 4005-4004	59	FP	From Middle Street and the access track to the dwellings of Bumbles Green Farm leading south-westwards adjacent to and on the north side of the ditch to a culvert where it deviates around a large tree over the culvert. Then immediately re-joining the north side of the ditch to a point opposite the property known as Jamesmead, approximately 220 mt south-west of Middle Road. Up to this point the path has a width of 1.5 mt and shall be no less than 1 metre from the brow of the ditch. Then continuing in the same direction to a point approximately 226 metres south-west of Middle Street. This section has a width of 1.5 mt and shall be no less than 2mt from the brow of the ditch, on the north side of the ditch.
	59a		<i>The second section numbered 59a continues.</i> Then continuing at a width of 1.22 metres in a south westerly direction for a distance of 35 metres, before crossing the boundary on to Selways where it continues in the same direction for 20 metres. It then turns south-south-east along the western boundary of Selways for a distance of 70 metres to meet the Waltham Road.

The path then splits into one section, with an unspecified width, leading Page 17 onwards to meet Waltham Road.

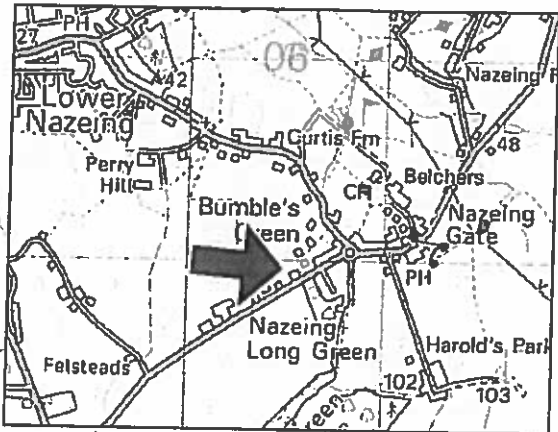

Key
Footpath 59 Nazeing

Delete Route A - D

Add Route G - B - H - D

Unaffected Route

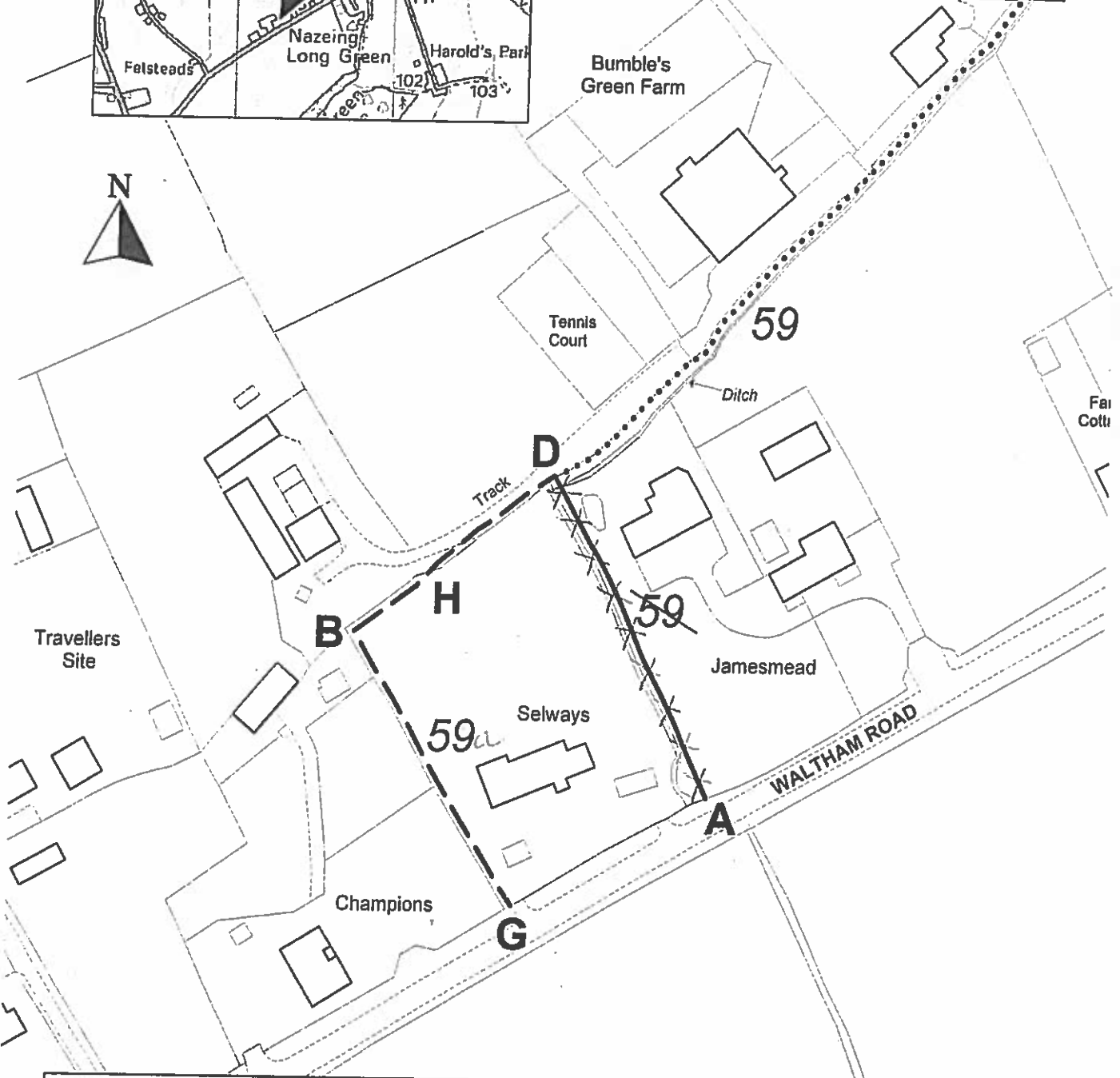

The Essex County Council Definitive Map Modification No. 617 (Footpath 59 Nazeing, Epping Forest District) Order 2016

Definitive Map Sheet TL40SW Scale 1:1250
Grid Ref TL406,049 or 5406,2049

Essex County Council

© Crown copyright and database rights
Ordnance Survey Licence No. 100019602

Wildlife and Countryside Act 1981

The Definitive Map and Statement for the County of Essex

The Essex County Council Definitive Map Modification No. 617
Footpath 59 Nazeing (Epping Forest District) Order 2016

This Order is made by Essex County Council under Section 53(2)(b) of the Wildlife and Countryside Act 1981 "the Act" because it appears to that authority that the Definitive Map and Statement for the County of Essex requires modification in consequence of the occurrence of an event specified in Section 53(3)(c)(i) & (iii) namely, the discovery by the authority of evidence which (when considered with all other relevant evidence available to them) shows (i) that a right of way which is not shown in the map and statement subsists or is reasonably alleged to subsist over land in the area to which the map relates, being a right of way to which this Part applies and (iii) that there is no public right of way over land shown in the map and statement as a highway of any description, or any other particulars contained in the map and statement require modification.

The authority has consulted with every local authority whose area includes the land to which the order relates. The Essex County Council hereby order that:

For the purpose of this order the relevant date is 1 February 2016.

The Definitive Map and Statement for the County of Essex shall be modified as described in Part I and Part II of the Schedule and shown on the map attached to the Order.

This order shall take effect on the date it is confirmed and may be cited as the Essex County Council Definitive Map Modification No. 617 Footpath 59 Nazeing (Epping Forest District) Order 2016.

Given under the Common Seal of the Essex County Council this 15 day of February in the year Two Thousand and Sixteen .

The COMMON SEAL of the ESSEX)
COUNTY COUNCIL was hereunto)
Affixed in the presence of:)

Attesting Officer

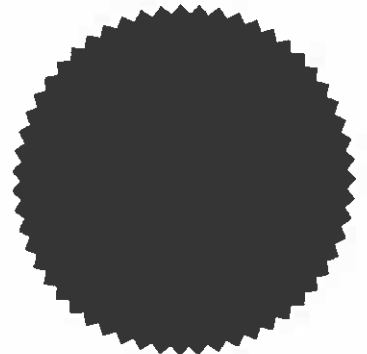

35177

The foregoing order is hereby confirmed
subject to the red ink modifications thereon

Mark Yates 24 APR 2018

An Inspector appointed by The Secretary
of State for Environment, Food and
Rural Affairs

SCHEDULE

PART I

Modification of Definitive Map

The footpath proceeds along the western and northern boundaries of the land held within Land Registry Title Number EX292306 (points G-B-H on the attached map). It then continues along the southern boundary of the land immediately to the north of registered Title Number EX292306 (points H-D on the attached map).

Description of path or way to be added:

A length of Footpath 59 Nazeing, from Waltham Road (Nazeing Long Green) at the western boundary of the property known as "Selways" in a north north westerly direction for a distance of 70 metres then turning north east for a distance of 55 metres to join the unaffected part of the route. The width of the added section is four feet (1.22 metres)

~~**Description of path or way to be deleted:**~~

~~A length of Footpath 59 Nazeing from a point D on the order plan in a south-south-easterly direction for a distance of 70 metres to meet the Waltham Road at Point A.~~

PART II

Modifications of Definitive Statement

Variations of particulars of path or way

The statement for the parish of Nazeing shall be amended to read as follows:

OS Sheet No.	Path No.	Classification	Position and Description
40 NW, SW 4005-4004	59 <i>59a</i>	FP	<p>From Middle Street and the access track to the dwellings of Bumbles Green Farm leading south-westwards adjacent to and on the north side of the ditch to a culvert where it deviates around a large tree over the culvert. Then immediately re-joining the north side of the ditch to a point opposite the property known as Jamesmead, approximately 220 mt south-west of Middle Road. Up to this point the path has a width of 1.5 mt and shall be no less than 1 metre from the brow of the ditch.</p> <p>Then continuing in the same direction to a point approximately 226 metres south-west of Middle Street. This section has a width of 1.5 mt and shall be no less than 2mt from the brow of the ditch, on the north side of the ditch.</p> <p><i>The second section numbered 59a continues.</i> Then continuing at a width of 1.22 metres in a south westerly direction for a distance of 35 metres, before crossing the boundary on to Selways where it continues in the same direction for 20 metres. It then turns south-south-east along the western boundary of Selways for a distance of 70 metres to meet the Waltham Road.</p>

The path then splits with one section, with an unspecified width, leading southwards to meet Waltham Road.

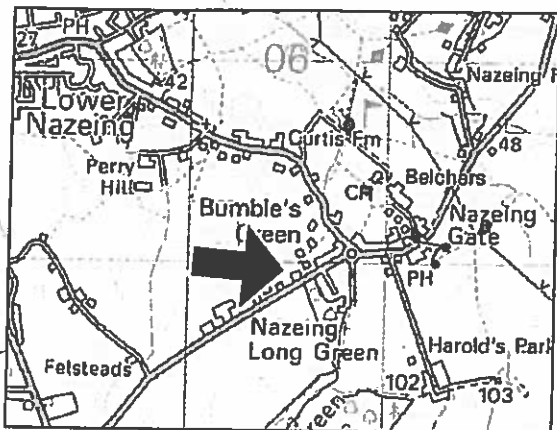

Key

Footpath 59 Nazeing

~~Delete Route A - D~~

Add Route G - B - H - D

Unaffected Route

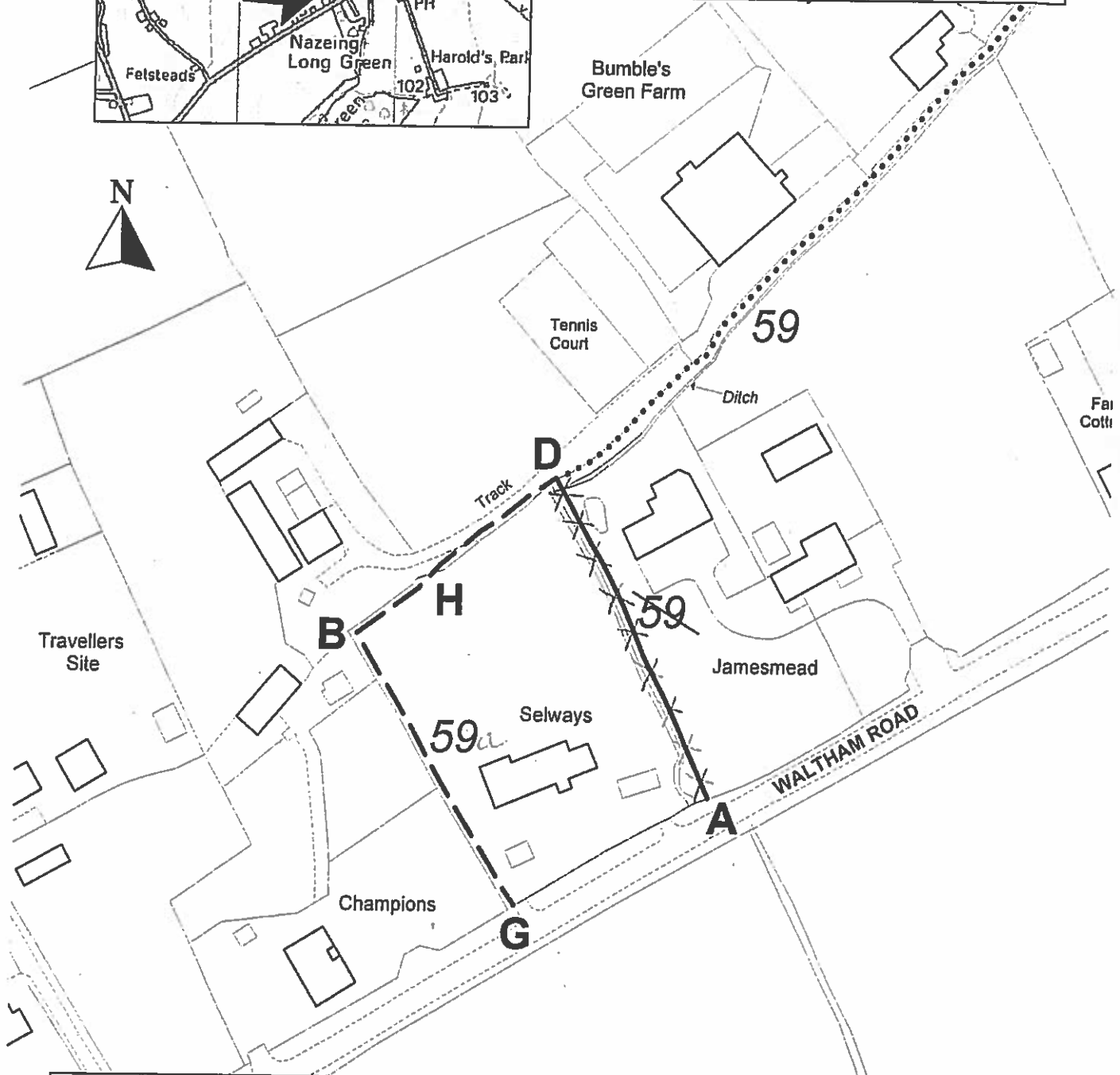

The Essex County Council Definitive Map Modification No. 617 (Footpath 59 Nazeing, Epping Forest District) Order 2016

Definitive Map Sheet TL40SW Scale 1:1250
Grid Ref TL406,049 or 5406,2049

Essex County Council

© Crown copyright and database rights
Ordnance Survey Licence No. 100019802

Public Notice

**TO THE PUBLIC AT LARGE AND TO THE OWNER AND OCCUPIER OF THE
LAND DESCRIBED BELOW**

Section 53 of the Wildlife and Countryside Act 1981
Definitive Map and Statement for the County of Essex
The Essex County Council Definitive Map

Modification No. 617 Footpath 59 Nazeing (Epping Forest District) 2016

NOTICE IS HEREBY GIVEN that the Secretary of State on 24 April 2018 confirmed the above mentioned Order and it took effect on that day.

The effect of the Order is to modify the Definitive Map for the County of Essex by:-

Adding a length of Footpath 59 Nazeing, from Waltham Road (Nazeing Long Green) at the western boundary of the property known as "Selways" in a north north westerly direction for a distance of 70 metres then turning north east for a distance of 55 metres to join the unaffected part of the route. The width of the added section is four feet (1.22 metres)

A copy of the Order and Order map may be seen free of charge during normal office hours at Epping Forest District Council Offices, Civic Centre, High Road, Epping, and at the Chelmsford Library, Market Road, Chelmsford, where copies will be available on request at a charge.

If any person is aggrieved by this Order and desires to question its validity on the ground that it is not within the powers of section 53 or that any of the requirements of Schedule 15 have not been complied with in relation to it, he may within 42 days from the date of publication of this Notice make an application to the High Court under paragraph 12(1) of Schedule 15 to the Act.

Dated: 3 May 2018

Paul Turner
Director, Legal and Assurance

ELS
Seax House
Victoria Road South
Chelmsford
CM1 1QH



Essex County Council

Public Notice

**TO THE PUBLIC AT LARGE AND TO THE OWNER AND OCCUPIER OF THE
LAND DESCRIBED BELOW**

Section 53 of the Wildlife and Countryside Act 1981
Definitive Map and Statement for the County of Essex
The Essex County Council Definitive Map

Modification No. 617 Footpath 59 Nazeing (Epping Forest District) 2016

NOTICE IS HEREBY GIVEN that the Secretary of State on 24 April 2018 confirmed the above mentioned Order and it took effect on that day.

The effect of the Order is to modify the Definitive Map for the County of Essex by:-

Adding a length of Footpath 59 Nazeing, from Waltham Road (Nazeing Long Green) at the western boundary of the property known as "Selways" in a north north westerly direction for a distance of 70 metres then turning north east for a distance of 55 metres to join the unaffected part of the route. The width of the added section is four feet (1.22 metres)

A copy of the Order and Order map may be seen free of charge during normal office hours at Epping Forest District Council Offices, Civic Centre, High Road, Epping, and at the Chelmsford Library, Market Road, Chelmsford, where copies will be available on request at a charge.

If any person is aggrieved by this Order and desires to question its validity on the ground that it is not within the powers of section 53 or that any of the requirements of Schedule 15 have not been complied with in relation to it, he may within 42 days from the date of publication of this Notice make an application to the High Court under paragraph 12(1) of Schedule 15 to the Act.

Dated: 3 May 2018

Paul Turner
Director, Legal and Assurance

ELS
Seax House
Victoria Road South
Chelmsford
CM1 1QH



Essex County Council

This page is intentionally left blank

ELS
Seax House
Victoria Road South
Chelmsford
CM1 1QH



ELS

First for Public Law

Epping Forest District Council
Civic Offices
High Street
Epping
Essex
CM16 4BZ

Our Ref: MM/HIGH/10016
Your Ref:
Date: 30 April 2018

Dear Sirs

Wildlife and Countryside Act 1981, section 53
The Essex County Council Definitive Map Modification No. 637 The Essex County Council Definitive Map Modification No 637 Footpath 22 Nazeing Epping Forest District Order 2018

With reference to previous correspondence, following consultations the County Council has made the above mentioned Order, two copies of which are enclosed, together with two copies of the formal Notice of the making of the Order.

I should be grateful if you would arrange for one of the copies of the Order and map contained in it to be deposited at your offices and to be available for public inspection, as indicated in the Notice which should be displayed in a prominent position at your offices (as required by Schedule 15 to section 53 of the Wildlife and Countryside Act 1981). The second copy of the Order and Notice are for your file purposes.

This Order, if confirmed, will modify the Definitive Map. May I suggest that for Land Charge purposes, you arrange for the Definitive Map to be amended in pencil with references in the remarks column of the Statement to the existence of this Order. If and when the Order is confirmed, the notes in the remark column should be supplemented and should give the date of confirmation of the Order. The confirmed Order would have to remain on deposit with the Definitive Map and Statement, which it modifies.

I draw your attention to the Department of the Environment's Circular 2/93, Annex D, Paragraph 3. This states that local planning authorities need to take into account any proposed modifications to the Definitive Map and possible existence of any other rights on the ways shown on the Map. I should be obliged, therefore, if you would ensure that the District Planner is aware of the Order.



Lexcel is the Law Society's legal practice quality mark for excellence.

Any enquiries regarding the content of the Order or the associated case should be directed to Mary Morris on 03330 139679.

Yours faithfully



Mary Morris
Chartered Legal Executive

DX 123300 Chelmsford 7

Telephone: 03330 139679

Fax: 01245 506650

Internet: www.elslegal.org.uk

Email: mary.morris@essex.gov.uk

Wildlife and Countryside Act 1981

The Definitive Map and Statement for the County of Essex

The Essex County Council Definitive Map Modification No. 637
Footpath 22 Nazeing, Epping Forest District Order 2018

This Order is made by Essex County Council under Section 53(2)(b) of the Wildlife and Countryside Act 1981 "the Act" because it appears to that authority that the Definitive Map and Statement for the County of Essex requires modification in consequence of the occurrence of an event specified in Section 53(3)(c)(i) & (iii) namely, the discovery by the authority of evidence which (when considered with all other relevant evidence available to them) shows (i) that a right of way which is not shown in the map and statement subsists or is reasonably alleged to subsist over land in the area to which the map relates, being a right of way to which this Part applies and (iii) that there is no public right of way over land shown in the map and statement as a highway of any description, or any other particulars contained in the map and statement require modification.

The authority has consulted with every local authority whose area includes the land to which the order relates. The Essex County Council hereby order that:

For the purpose of this order the relevant date is 12 February 2018.

The Definitive Map and Statement for the County of Essex shall be modified as described in Part I and Part II of the Schedule and shown on the map attached to the Order.

This order shall take effect on the date it is confirmed and may be cited as the Essex County Council Definitive Map Modification No. 637 Footpath 22 Nazeing Epping Forest District Order 2018

Given under the Common Seal of the Essex County Council this
21 day of *March* in the year Two Thousand and Eighteen

The COMMON SEAL of the ESSEX
COUNTY COUNCIL was hereunto
Affixed in the presence of:

Attesting Officer

)
)
)
[Signature]
SARAH SMART

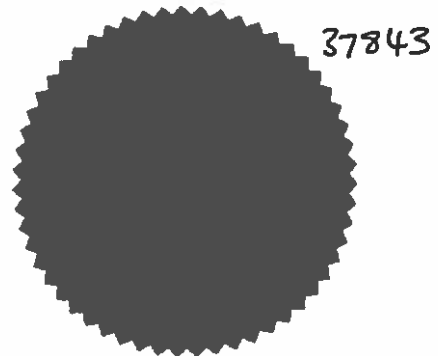

SCHEDULE**PART I****Modification of Definitive Map****Description of path or way to be added:**

A length of Footpath 22 Nazeing, from Point A on the order plan in a generally northerly direction for a distance of approximately 70 metres then turning north west for another 70 metres to Point D. From here it turns north- north- east for approximately 250 metres to join Footpath 21 at Point C. The width of the way is 1.5 metres; and that of the unaffected, southerly 18.25 metre section of Footpath 22 is 2.4 metres.

Description of path or way to be deleted

A length of Footpath 22 Nazeing from Point A on the order plan in a generally northerly direction for approximately 250 metres to Point B before turning north-north- east for a distance of approximately 130 metres to join Footpath 21 at Point C

PART II**Modifications of Definitive Statement****Variations of particulars of path or way**

The statement for the parish of Nazeing shall be amended by the substitution of the entry for Footpath 22 with the following : -

OS Sheet No.	Pat h No.	Clas sifica tion	Position and Description
40 NW,S W 4004- 4005	22	FP	. From Waltham Road in a in a generally northerly direction for 90 metres then turning north- west for a distance of approximately 70 metres. From here the route turns north-north-east for a distance of approximately 250 metres to meet Footpath 21. The width of the initial 18.25 metres heading north from Waltham Road is 2.4 metres reducing to 1.5 metres for the remainder of its length..

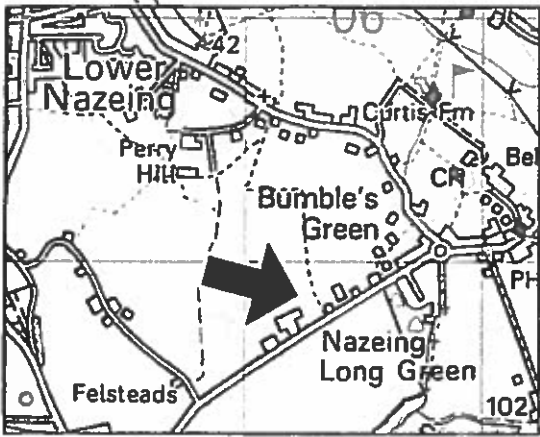

Key

Footpath 22 Nazeing

Delete Route A - B - C

Add Route A - D - C

Unaffected Route

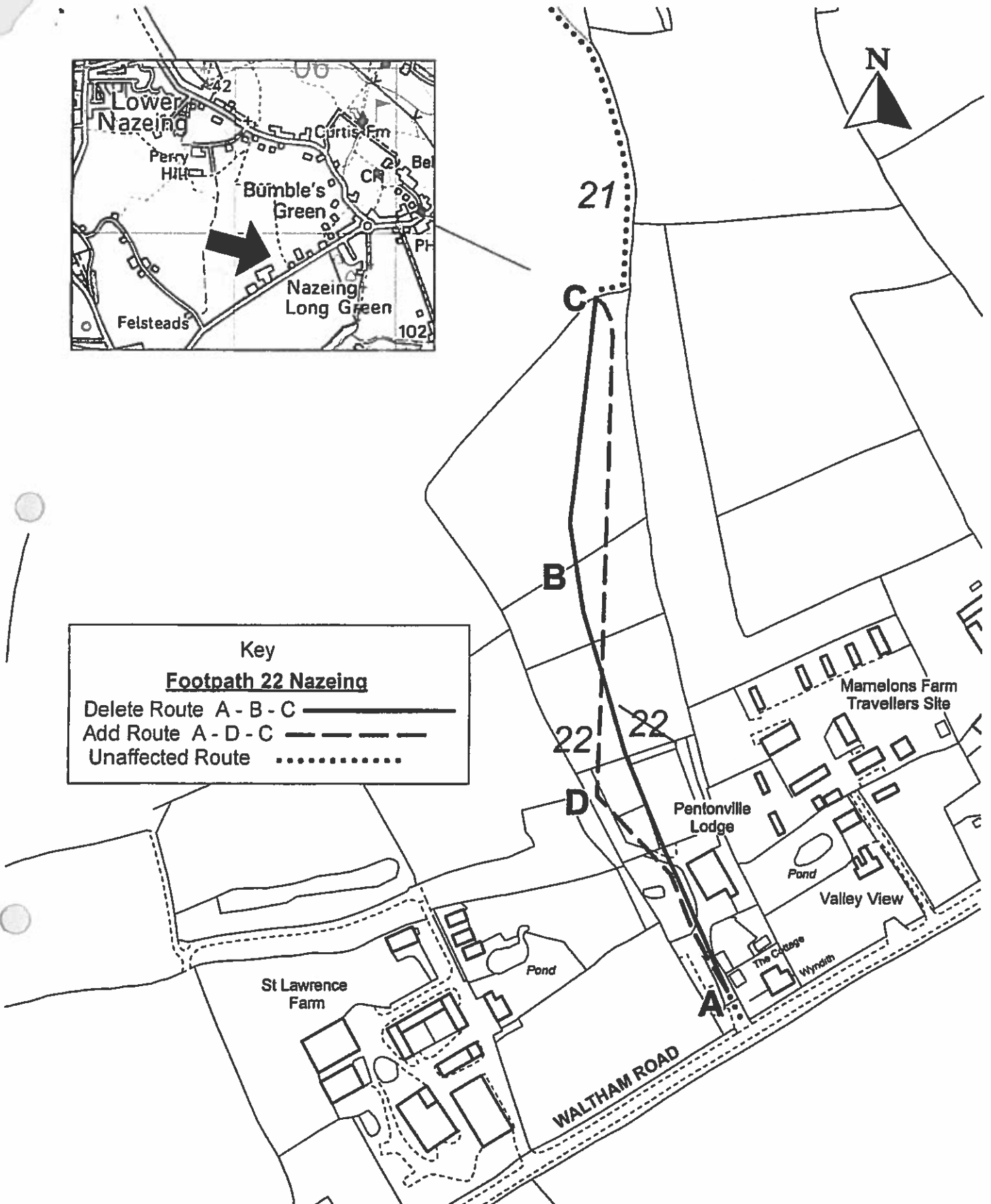

**The Essex County Council Definitive Map
Modification No.637 (Footpath 22 Nazeing,
Epping Forest District) Order 2018**

Map Sheets TL40SW & TL40NW Scale 1:2500
Grid Ref TL 403,050

Essex County Council

© Crown copyright and database rights
Ordnance Survey Licence No. 100019602

Wildlife and Countryside Act 1981

The Definitive Map and Statement for the County of Essex

The Essex County Council Definitive Map Modification No. 637
Footpath 22 Nazeing, Epping Forest District Order 2018

This Order is made by Essex County Council under Section 53(2)(b) of the Wildlife and Countryside Act 1981 "the Act" because it appears to that authority that the Definitive Map and Statement for the County of Essex requires modification in consequence of the occurrence of an event specified in Section 53(3)(c)(i) & (iii) namely, the discovery by the authority of evidence which (when considered with all other relevant evidence available to them) shows (i) that a right of way which is not shown in the map and statement subsists or is reasonably alleged to subsist over land in the area to which the map relates, being a right of way to which this Part applies and (iii) that there is no public right of way over land shown in the map and statement as a highway of any description, or any other particulars contained in the map and statement require modification.

The authority has consulted with every local authority whose area includes the land to which the order relates. The Essex County Council hereby order that:

For the purpose of this order the relevant date is 12 February 2018.

The Definitive Map and Statement for the County of Essex shall be modified as described in Part I and Part II of the Schedule and shown on the map attached to the Order.

This order shall take effect on the date it is confirmed and may be cited as the Essex County Council Definitive Map Modification No. 637 Footpath 22 Nazeing Epping Forest District Order 2018

Given under the Common Seal of the Essex County Council this
21 day of *March* in the year Two Thousand and Eighteen

The COMMON SEAL of the ESSEX
COUNTY COUNCIL was hereunto
Affixed in the presence of:

Attesting Officer:

[Signature]
SARAH SMART

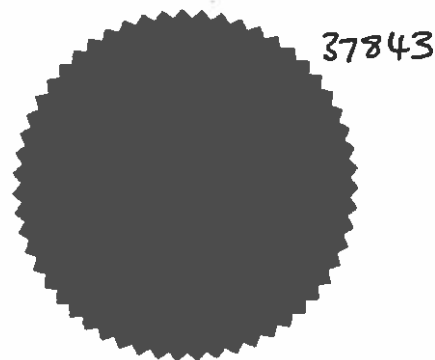

SCHEDULE**PART I****Modification of Definitive Map****Description of path or way to be added:**

A length of Footpath 22 Nazeing, from Point A on the order plan in a generally northerly direction for a distance of approximately 70 metres then turning north west for another 70 metres to Point D. From here it turns north- north- east for approximately 250 metres to join Footpath 21 at Point C. The width of the way is 1.5 metres; and that of the unaffected, southerly 18.25 metre section of Footpath 22 is 2.4 metres.

Description of path or way to be deleted

A length of Footpath 22 Nazeing from Point A on the order plan in a generally northerly direction for approximately 250 metres to Point B before turning north-north- east for a distance of approximately 130 metres to join Footpath 21 at Point C

PART II**Modifications of Definitive Statement****Variations of particulars of path or way**

The statement for the parish of Nazeing shall be amended by the substitution of the entry for Footpath 22 with the following : -

OS Sheet No.	Pat h No.	Clas sifica tion	Position and Description
40 NW,S W 4004- 4005	22	FP	. From Waltham Road in a in a generally northerly direction for 90 metres then turning north- west for a distance of approximately 70 metres. From here the route turns north-north-east for a distance of approximately 250 metres to meet Footpath 21. The width of the initial 18.25 metres heading north from Waltham Road is 2.4 metres reducing to 1.5 metres for the remainder of its length..

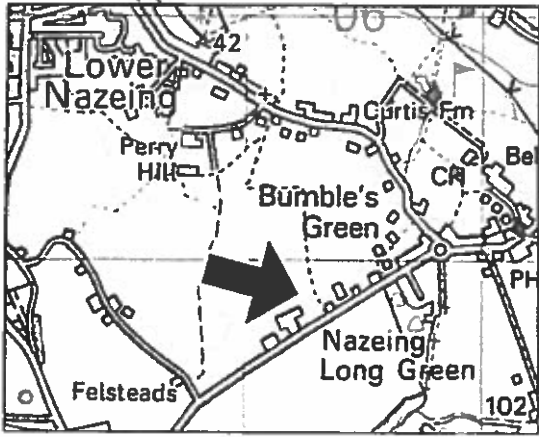

Key

Footpath 22 Nazeing

Delete Route A - B - C

Add Route A - D - C

Unaffected Route

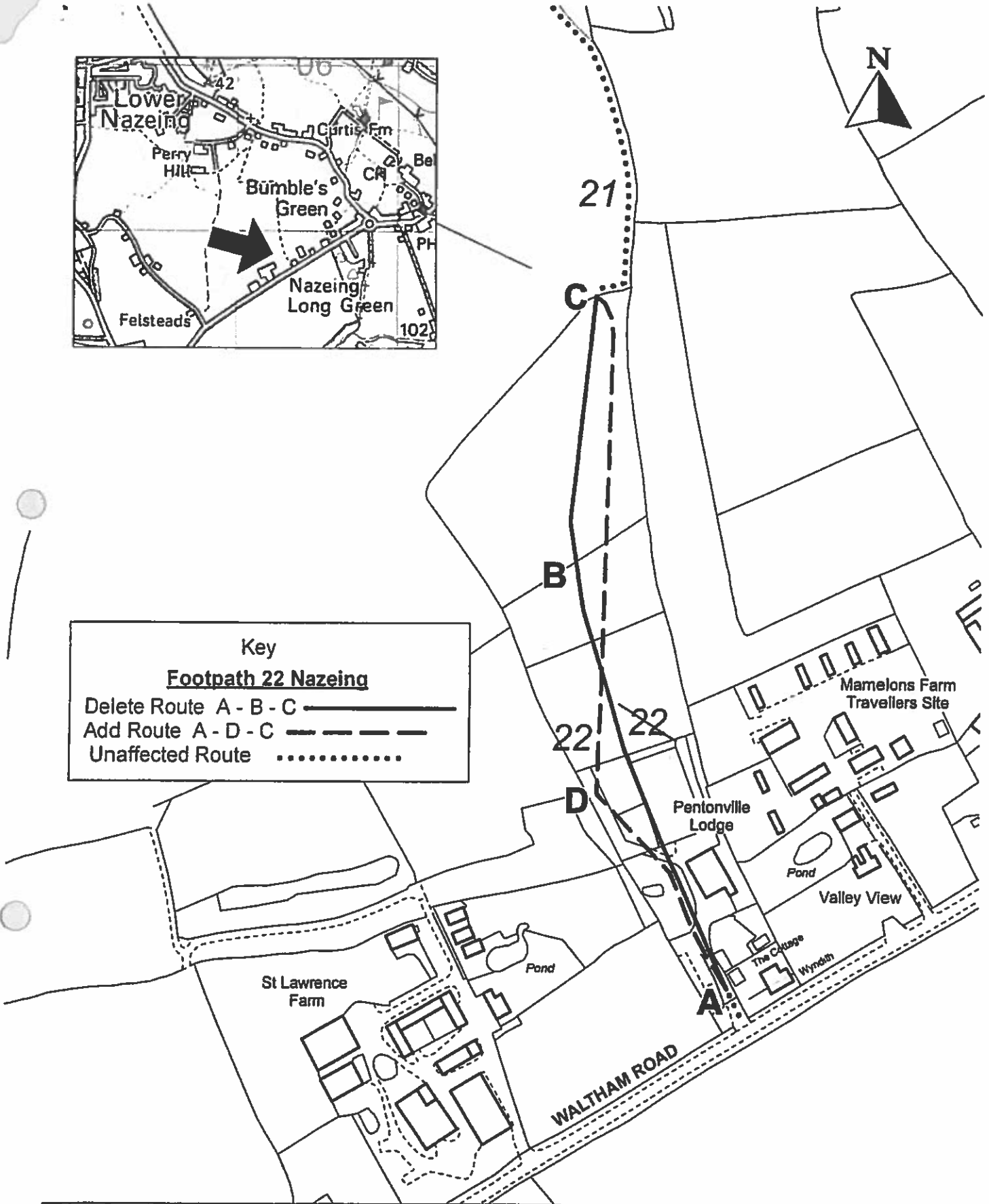

**The Essex County Council Definitive Map
Modification No.637 (Footpath 22 Nazeing,
Epping Forest District) Order 2018**

Map Sheets TL40SW & TL40NW Scale 1:2500
Grid Ref TL 403,050

Essex County Council

© Crown copyright and database rights
Ordnance Survey Licence No. 100019602

Public Notice

TO THE PUBLIC AT LARGE AND TO THE OWNER AND OCCUPIER OF THE LAND DESCRIBED BELOW

Section 53 Wildlife and Countryside Act 1981

Definitive Map and Statement for the County of Essex

The Essex County Council Definitive Map
Modification No. 637 The Essex County Council Definitive Map Modification No 637
Footpath 22 Nazeing Epping Forest District Order 2018

The above Order made on 21 March 2018, if confirmed as made, will modify the Definitive Map for the area by:-

1. Adding length of Footpath 22 Nazeing, from Point A on the order plan in a generally northerly direction for a distance of approximately 70 metres then turning north west for another 70 metres to Point D. From here it turns north- north- east for approximately 250 metres to join Footpath 21 at Point C. The width of the way is 1.5 metres; and that of the unaffected, southerly 18.25 metre section of Footpath 22 is 2.4 metres.
2. Deleting a length of Footpath 22 Nazeing from Point A on the order plan in a generally northerly direction for approximately 250 metres to Point B before turning north- north- east for a distance of approximately 130 metres to join Footpath 21 at Point C

A copy of the Order and the Order map may be seen free of charge during normal office hours at Epping Forest District Council , and at the Chelmsford Library, Market Road, where copies will be available on request at a charge.

Any representation or objection relating to the Order must be sent in writing to the Director for Essex Legal Services, Essex County Council, Seax House, Victoria Road South, Chelmsford, Essex, CM1 1QH, to arrive not later than 21 June 2018, and it is requested that the grounds on which it is made are stated.

If no representations or objections are duly made to the Order, or if any so made are withdrawn, the Essex County Council, instead of submitting the Order to the Secretary of State, may itself confirm the Order. If the Order is submitted to the Secretary of State for the Environment, Food and Rural Affairs, any representations or objections, which have been duly made and not withdrawn, will be sent with it.

Dated 3 May 2018



Paul Turner
Director, Legal and Assurance



Essex County Council

Public Notice

TO THE PUBLIC AT LARGE AND TO THE OWNER AND OCCUPIER OF THE LAND DESCRIBED BELOW

Section 53 Wildlife and Countryside Act 1981

Definitive Map and Statement for the County of Essex

The Essex County Council Definitive Map
Modification No. 637 The Essex County Council Definitive Map Modification No 637
Footpath 22 Nazeing Epping Forest District Order 2018

The above Order made on 21 March 2018, if confirmed as made, will modify the Definitive Map for the area by:-

1. Adding length of Footpath 22 Nazeing, from Point A on the order plan in a generally northerly direction for a distance of approximately 70 metres then turning north west for another 70 metres to Point D. From here it turns north- north- east for approximately 250 metres to join Footpath 21 at Point C. The width of the way is 1.5 metres; and that of the unaffected, southerly 18.25 metre section of Footpath 22 is 2.4 metres.
2. Deleting a length of Footpath 22 Nazeing from Point A on the order plan in a generally northerly direction for approximately 250 metres to Point B before turning north- north- east for a distance of approximately 130 metres to join Footpath 21 at Point C

A copy of the Order and the Order map may be seen free of charge during normal office hours at Epping Forest District Council , and at the Chelmsford Library, Market Road, where copies will be available on request at a charge.

Any representation or objection relating to the Order must be sent in writing to the Director for Essex Legal Services, Essex County Council, Seax House, Victoria Road South, Chelmsford, Essex, CM1 1QH, to arrive not later than 21 June 2018, and it is requested that the grounds on which it is made are stated.

If no representations or objections are duly made to the Order, or if any so made are withdrawn, the Essex County Council, instead of submitting the Order to the Secretary of State, may itself confirm the Order. If the Order is submitted to the Secretary of State for the Environment, Food and Rural Affairs, any representations or objections, which have been duly made and not withdrawn, will be sent with it.

Dated 3 May 2018



Paul Turner
Director, Legal and Assurance



Essex County Council

Agenda Item 4

Chairman's Events

Date	Time	Event	Venue	Attending
Sunday 13 May	9.45am	Mayor of Chelmsford End of Term Service	Church of Our Saviour, Chelmer Village	Chairman of Council
Tuesday 15 May		Garden Party	Buckingham Palace	Chairman of Council
Tuesday 27 May	6.00pm	Youth Council Elections Results	Civic Offices	Chairman of Council

This page is intentionally left blank